

FRESNO INDUSTRIAL CENTER

FRESNO, CA.

(559)-225-6363

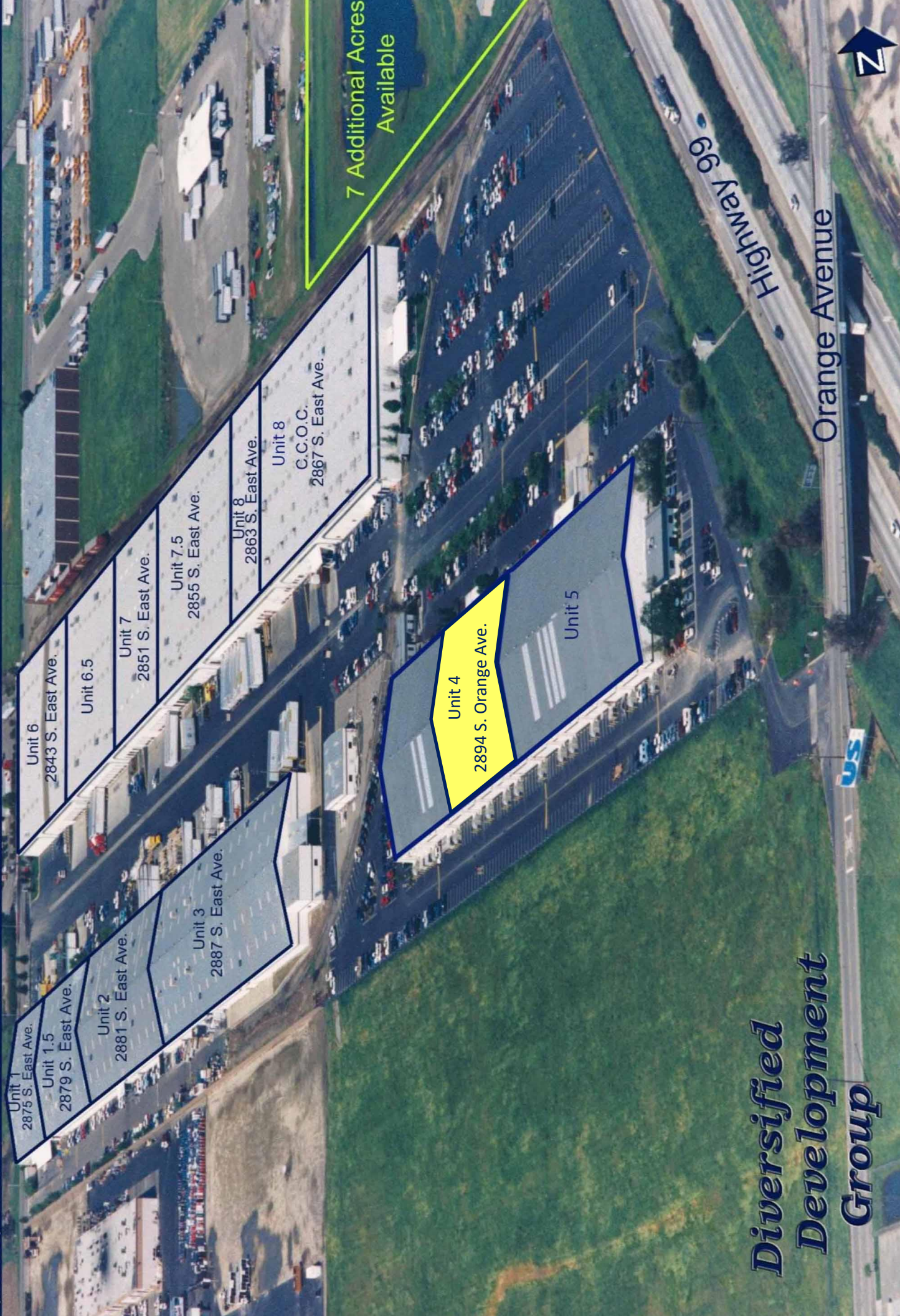

Unit 1
2875 S. East Ave.

Unit 1.5
2879 S. East Ave.

Unit 2
2881 S. East Ave.

Unit 3
2887 S. East Ave.

Unit 6
2843 S. East Ave.

Unit 6.5
2851 S. East Ave.

Unit 7
2855 S. East Ave.

Unit 7.5
2863 S. East Ave.

Unit 8
C.C.O.C.
2867 S. East Ave.

Unit 4
2894 S. Orange Ave.

Unit 5

7 Additional Acres Available

Highway 99

Orange Avenue



*Diversified
Development
Group*



Unit 4

30,720 SF Available

REVISIONS	

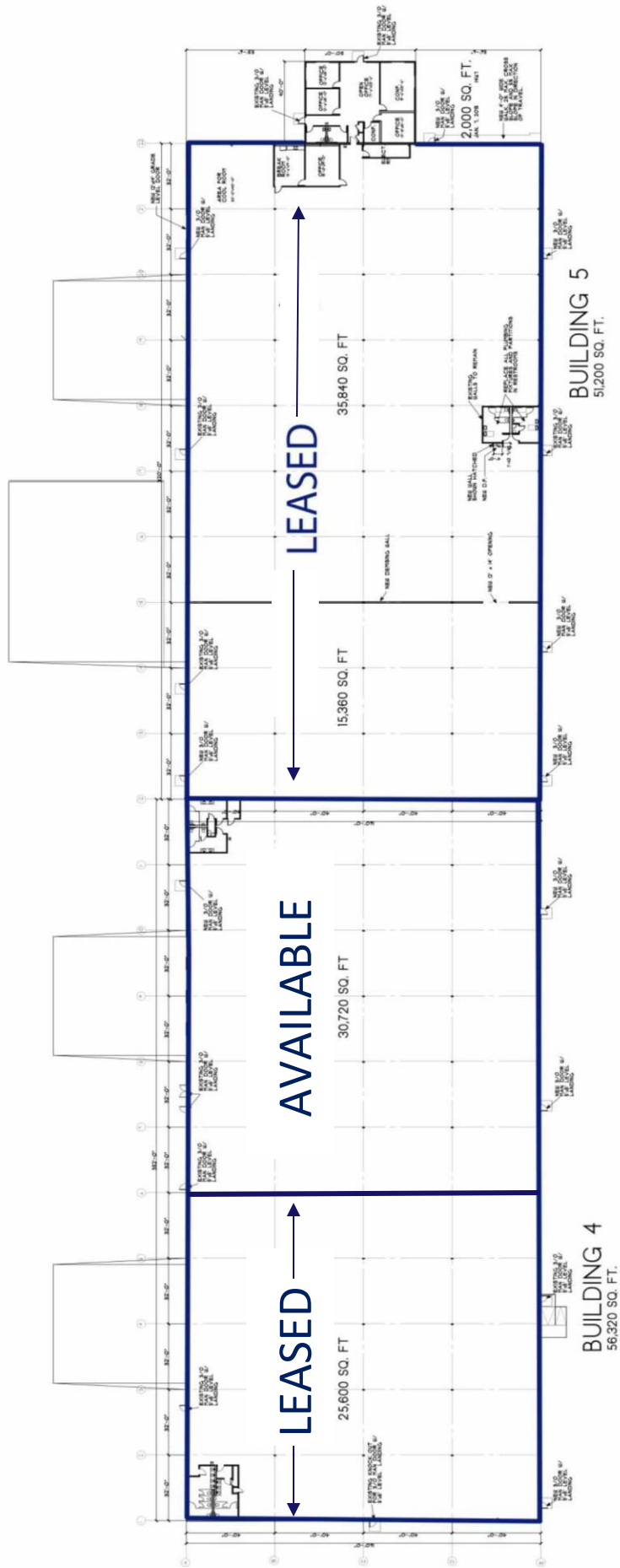

Walter Ingersoll
Professional Engineer
State of Florida
License No. 12577
Exp. 12/31/2024

DATE: JAN. 28, 2024
JOB NO.: 1847
A-3
OF SHEETS

FRESNO INDUSTRIAL CENTER

UNIT 4

TOTAL SIZE:	30,720 SF
DIMENSIONS:	192' x 160'
DIVISIBLE:	30,720 SF
BAY SIZE:	32' x 160' = 5,120 sq.ft.
COLUMN SPACING:	40' x 32'
CONCRETE WALLS:	6"
CONCRETE SLAB:	6"
CLEAR HEIGHT:	17' on sides and 29' in center
ROOF CONSTRUCTION:	Metal Roof
POWER EXHAUST VENTS:	One (1) Roof Mounted Power Exhaust Vent
TRUCK DOCKS:	Four (4) dock high doors
DOCK APRON:	60' Reinforced 6" concrete
GRADE LEVEL DOORS:	Two (2) 16' x 14' grade level doors
FIRE SYSTEM:	ESFR- 200 HP fire pump system
ELECTRICAL:	200 amp 277/480v subpanel with Transformer and 120/208v subpanel. 1,200 amp 277/480v, 3ph 4w
WAREHOUSE LIGHTING:	LED
ADDRESS:	2894 S. Orange Avenue, Fresno, CA 93725

For further information please contact

Marcus Pignotti

559.225.636 Ext. 8